

CREEK BEND WAY, WASHINGTON TOWNSHIP, OH 45458, USA

<https://www.flourishteam.com>

\$ 55,000.00

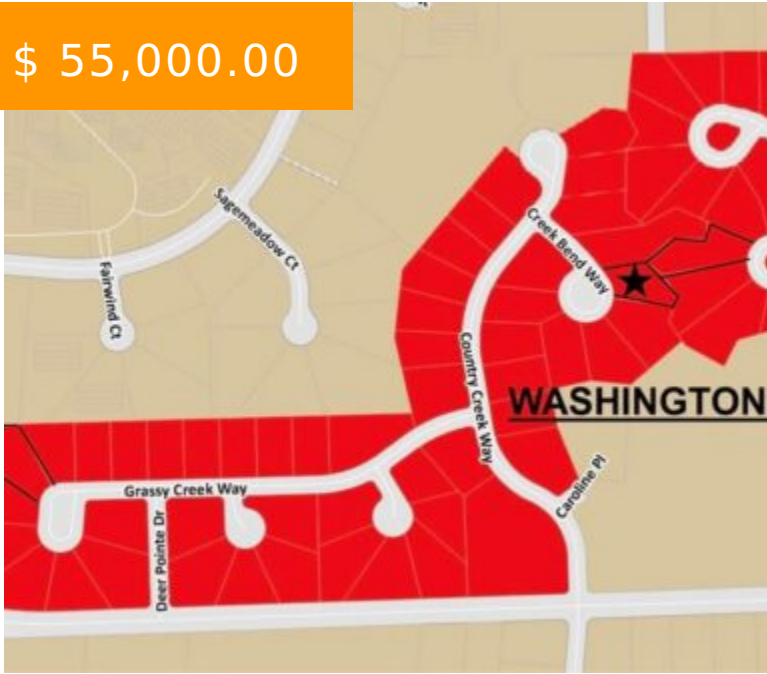

Located in cul-de-sac. Creek in rear of lot. Possible walk-out lower level. You can bring your own builder. The building plan is subject to the approval of the association's design review committee. Association fee is \$285 quarterly which covers common area maintenance.

- Single Family Lot
- Land
- Active



CALL US NOW

Phone: (937) 637-7333

Address: 1210 Meadow Bridge Drive, Suite C, Beavercreek, OH 45434

BASIC FACTS

Date added: 11/04/21

Type: Single Family Lot

Acres: 0.3700

MLS #: 843141

Post Updated: 2021-11-04 13:53:45

Status: Active

Lot size: 16117 sq ft

Listing Contract Date: 2021-06-24

LOCATION DETAILS

County Or Parish: Montgomery

School District: Centerville

Directions: From OH48, East on Nutt Rd.,
Left on Country Creek Way, Right on Creek
Bend Way to Lot #11

Zoning: Residential

PROPERTY DETAILS

Lot Dimensions: .

Parcel Number: O67 29001 0011

Subdivision Name: Hidden Crk Sec 02

Distressed Property: None

Transaction Type: Sale

PROPERTY FEATURES

Utilities: City Water,Sanitary Sewer,Storm
Sewer,Utilities at Street

Road Type: .

Frontage: .

Timber: .

MISCELLANEOUS

CALL US NOW

Phone: (937) 637-7333

Address: 1210 Meadow Bridge Drive, Suite C, Beavercreek, OH 45434

Taxes Semi Annual: 156.56

Assessments: of record

CALL US NOW

Phone: (937) 637-7333

Address: 1210 Meadow Bridge Drive, Suite C, Beavercreek, OH 45434